



Dual Screen PACS Station - Retro-Fit

Overview

The Starkstrom Dual Screen PACS Station has been specifically designed for the clinical environment. Its design and construction is based upon our extensive experience and knowledge gained from manufacturing and supplying a broad range of products specifically meant for operating theatres and other high care areas.

The retro-fit PACS station is designed to be mounted into an existing Stainless Steel Control Panel and consists of either dual 19" or 20" colour screens.

The unit is supplied with a fully retractable keyboard and mouse which is wipe clean making disinfection by clinical staff extremely easy.

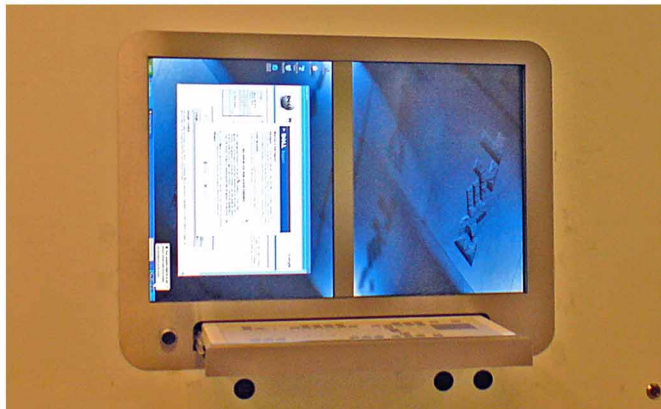

Technology

The PACS Station is based upon Intel® Pentium® technology and features a 2.80GHz processor with 512MB DDRII RAM and a 40GB hard drive. Network cabling (10/100 BaseT LAN) may be run straight into the unit providing instant access to the IT infrastructure.

19" and 20" colour LCD monitors are available. The specification of the monitors are as follows:

19"
Resolution: 1280 x 1024 / 75Hz
Image brightness: 250cd/m2
Image contrast ratio: 500:1

20" - DICOM
Resolution: 1600 x 1200 / 75Hz
Image brightness: 280cd/m2
Image contrast ratio: 700:1
Includes DICOM calibration, quality control and acceptance software.

Starkstrom, 256 Field End Road, Eastcote, Ruislip, Middlesex HA4 9UW
Tel: 020 8868 3732 Fax: 020 8868 3736 Email: info@starkstrom.com

The picture below shows a typical Stainless Steel Control Panel that has a 2-way X-Ray viewer installed. Our retro-fit solution means that the 2-way viewer can simply be taken out and replaced with a Twin Screen PACS station.

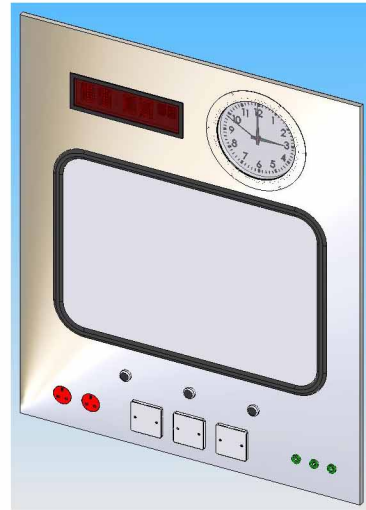

As can be seen below, the Stainless Steel Control Panel has now been fitted with a Twin Screen PACS Station that sits neatly in the window where the x-ray viewer was. The unit has a fully retractable wipeclean keyboard too which makes cleaning and disinfecting of the unit very easy.

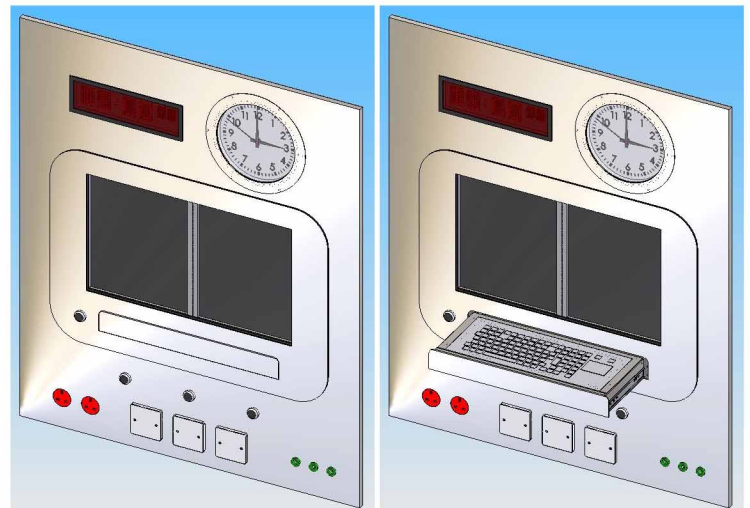

Specifications

Description: Retro-fit dual screen PACS station consisting of two 19" or 20" colour monitors.